



Installation Instructions

'79-'04 Mustang Drag Strut #30030



Installation Instructions

1. Install caster/camber plate to chassis following the plate manufacturer's instructions
2. Attach the strut to the spindle using the factory M16 bolts and nuts and leave loose. If necessary, the aluminum spacers can be removed from the clevis to accommodate wider spindles.
3. Install the following items in order onto the strut: coilover nut, spring, bump stop, upper spring seat, bearing washer (with grease), upper bearing seat, and one caster/camber plate bushing.
4. Insert strut shaft through caster/camber plate. It may be necessary to have an assistant support the strut and spindle while the upper components are being installed.
5. Install upper caster/camber bushing, install the 5/8" locking nut onto the shaft, and torque the nut to 60 ft. lbs.
6. After final tightening of nut, install detent clip, knob, lock-washer, and #8 screw.
7. Torque the lower strut/spindle nuts to 170 ft. lbs.
8. After setting ride height(s), tighten #12 bolt on coilover locking ring to secure coilover nut in position on the strut body.

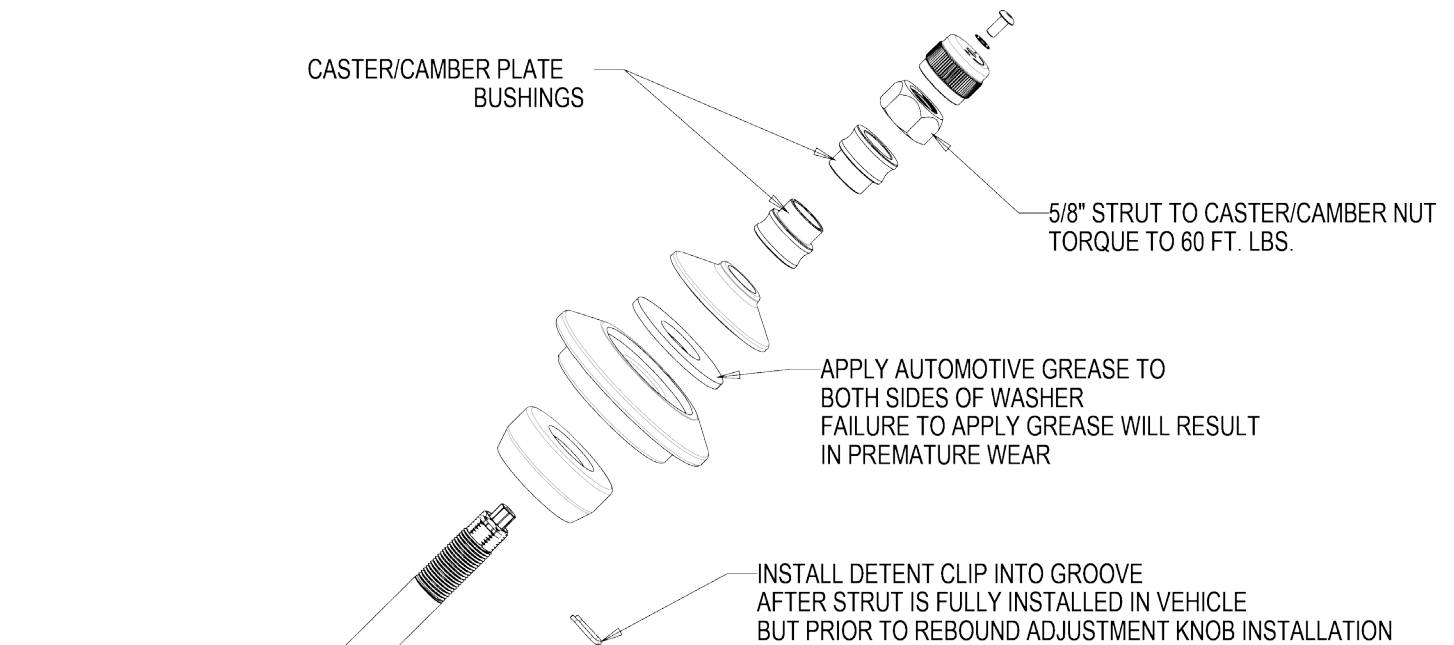

FIGURE 1: Strut Upper Mount View

TORQUE SPECIFICATIONS		
Component	Thread Size	Torque
Strut to Spindle Bolts	M16	170 ft. lbs.
Strut to Caster/Camber Plate	5/8-18	60 ft. lbs.
Caster/Camber Plate to Chassis	7/16-14	50 ft. lbs.
Caster/Camber Plate to Chassis	3/8-16	30 ft. lbs.

TABLE 1: Product Torque Specifications

Adjustment Instructions

- Rebound is adjusted by turning the knob at the end of the shaft.
- Compression is adjusted by turning the knob at the base of the strut body.
- There are 36-40 “clicks” of adjustment for rebound. There are 22-26 “clicks” of adjustment for compression.
- To choose a firmer damping setting, turn the adjustment knob clockwise. To choose a softer damping setting, turn the adjustment knob counter-clockwise.
- Adjustment settings should always be based off the firmest setting for consistency. For instance, setting each strut “10-clicks” from full firm will yield the closest matched pair of settings between the two struts.
- The adjustments are most sensitive toward the firmest settings. Therefore, the first 10 clicks from full firm will have the greatest affect. Conversely, the last 10 clicks before full soft will have the least affect.
- If the adjustment range of this product is not adequate for its application, AFCO has the ability to custom valve this product. Call us at 1-800-632-2320 and let us know how we can help.

NOTICE REGARDING REBOUND ADJUSTMENT

AFCO 30030 struts utilize a pressure-energized needle inside of the shaft that adjusts rebound. Once an adjustment is made on rebound, the shock must be compressed with a short, but quick, stroke to adjust the needle to the set position. During normal operation, this adjustment is activated by the normal motion of the vehicle's suspension. The occurs even at very low speeds and strokes (i.e. driving through the pits or up to the starting line).

When stroking the strut by hand, the rebound may feel as if it is not changing when an adjustment is made. However, a quick compression stroke will set the needle appropriately so the rebound change(s) can be felt. Often, this compression stroke is accompanied by an audible “click” from inside the strut which is the rebound needle moving into position

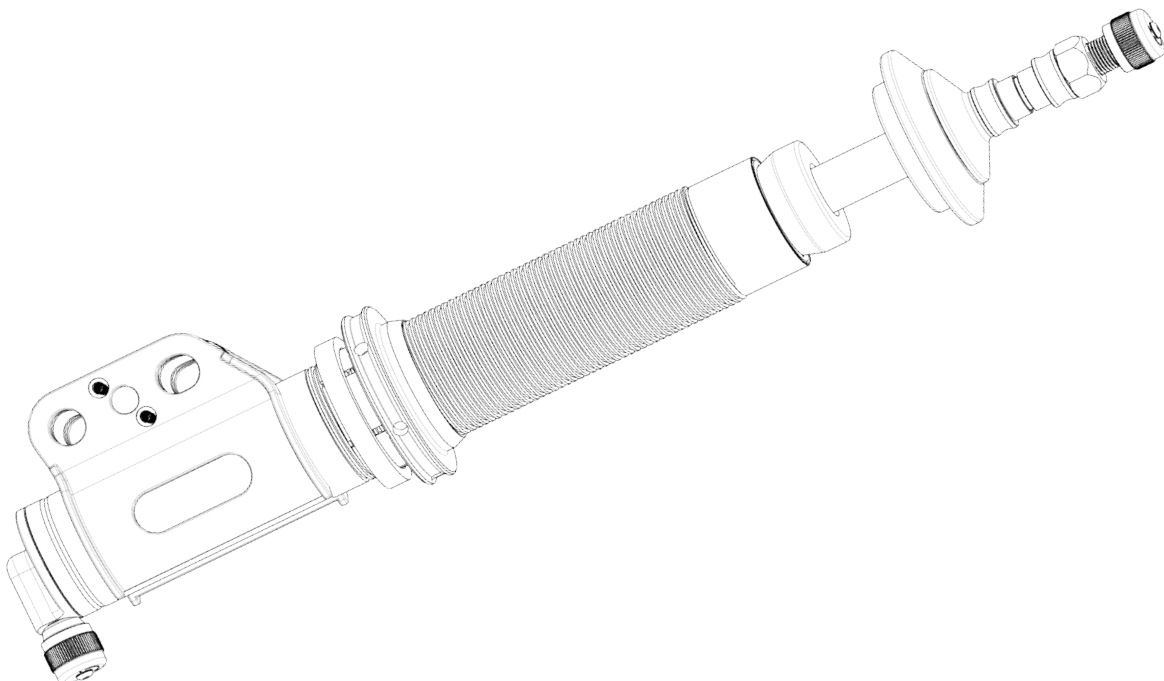



CHECK US OUT ON THE WEB!

AFCO has been dedicated to building speed, power and performance for over three decades. For more information on our Suspension, Cooling and Brake components, find us online at AFCOracing.com.

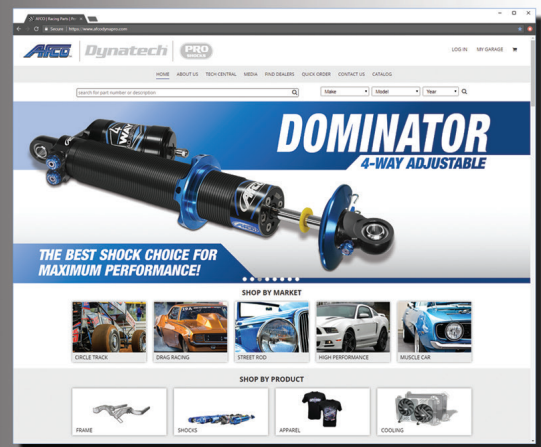

FOLLOW US ON FACEBOOK!

For the latest news from AFCO Racing Products on new product development, technical bulletins, travel schedules, how-to manuals and event results, find us online at facebook.com/AFCORacingProducts.

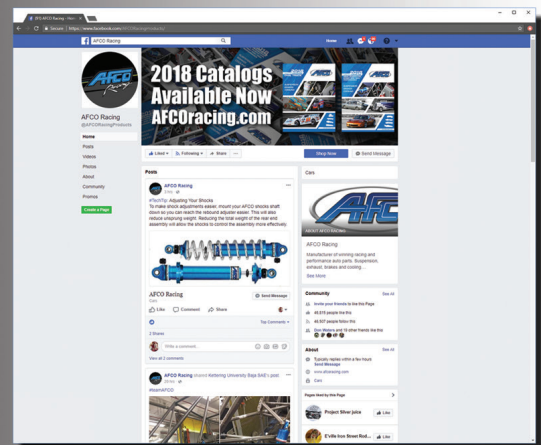

Stay connected

www.AFCOracing.com | AFCOracingcs@AFCOracing.com
800-632-2320 | 977 Hyrock Blvd. Boonville, IN 47601

LIT-595 Rev. B, Copyright 2017 - AFCO Performance Group